

How to assemble and use the Sharpsafe® 4 & 7 Litre sharps container

ASSEMBLY INSTRUCTIONS

1. Place base of container on a firm surface for assembly (e.g. a table).
2. Attach lid to base of container by firmly applying pressure to each corner in turn (Fig.1).
3. Ensure all four corners engage with a “click”.
4. Complete relevant sections of label including name and date of assembly.

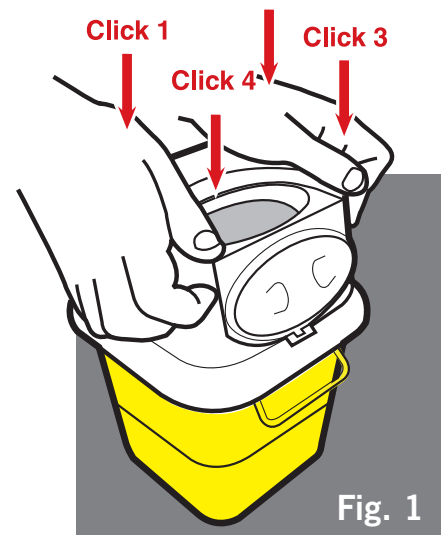

Fig. 1

USER INSTRUCTIONS

1. Temporary closure:- Rotate cover over the aperture. Apply light pressure until a “click” is heard (Fig.2).
2. Temporary closure release:- Push tab (Fig.3). Cover will release and open.
3. Do not fill above line indicated where clear lid meets yellow base.
4. Final closure:- Rotate cover over the aperture applying firm pressure with thumbs to indentations (Fig.4). Ensure tab and both side clips engage.
5. Complete all relevant sections of the label including name and date of closure.

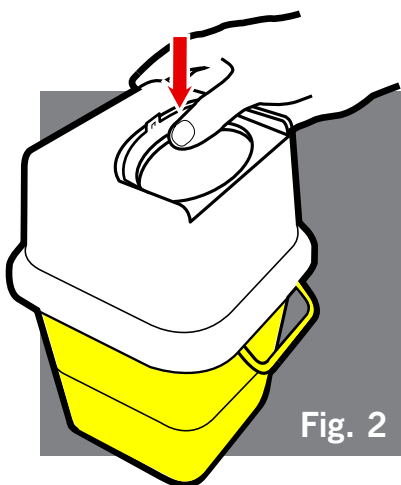

Fig. 2

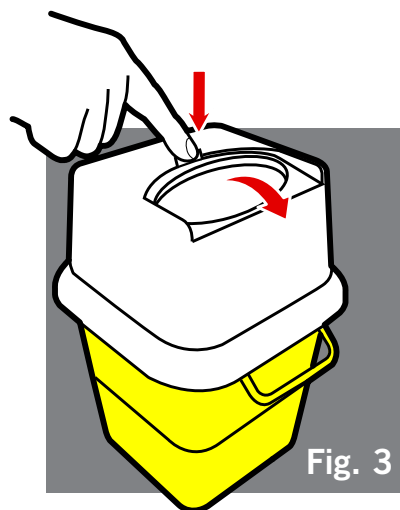

Fig. 3

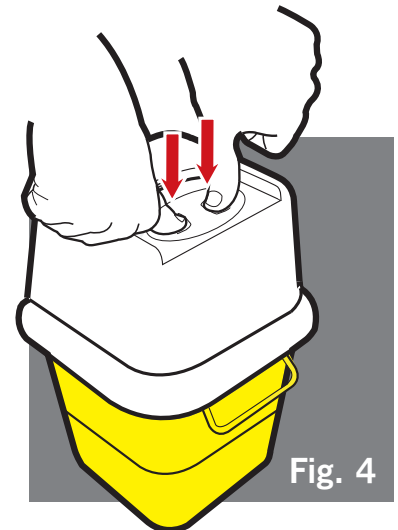

Fig. 4